

# Super TC-18

## A Low Cost Network Terminal

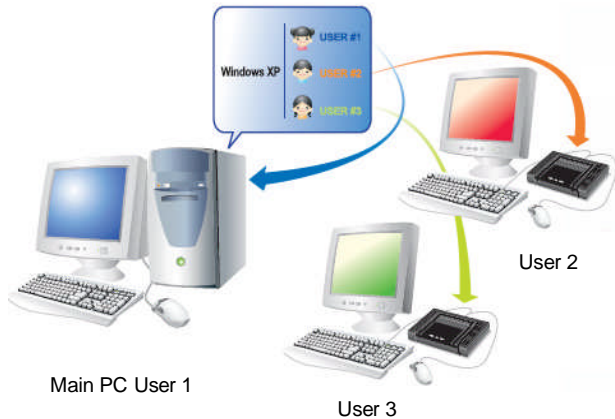

### Key Benefits of TC-18

With TC-18, you enjoy numerous benefits including:

- Lowest total cost of ownership (for additional PCs)
- No maintenance/upgrade (except just for the Host PC)
- No PC de-appreciation cost
- No Wastage of PC resources
- Super Energy Saving
- Enhanced Security via own encryption and password
- Remote accessibility of your office/home PC via internet
- Wide application usage for both businesses and homes
- Simple to install and ease to use
- Small and Sleek Design

### What is Super TC-18?

Super TC-18 is an ideal and low cost network terminal that does not have any CPU, hard-disk, CD-ROM but yet it can still perform the usual PC functions. Thus, it is appealing to many businesses and applications as it can help to reduce the overall IT and operation cost significantly over the years.

### How Does Super TC-18 Works?

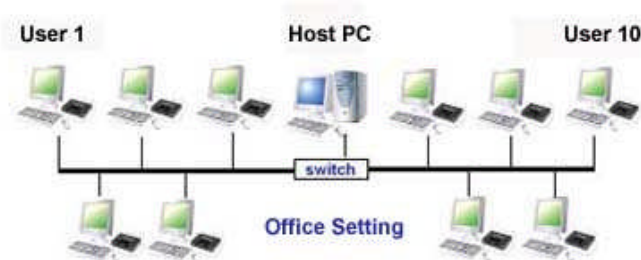

Up to 10 Super TC-18s can be connected to a host PC via LAN. Each TC-18 can operate like a separate PC without decreasing the overall performance of the Host PC. By sharing the resources of the Host PC, each TC-18 can run any applications from the Host PC independently and securely.

Other than for usual business usage, TC-18 is also very suitable for home users. Multiple Home users can enjoy the benefits of additional computing capabilities with just one main PC. Each family member can browse internet or work on reports at the same time without having to queue for the same PC.



### Where can TC-18 be used?

- Small and Medium Enterprises (SME)
- Small Offices Home Offices (SOHO)
- Production Factories
- Education/Training Centers/Schools
- Call Centers
- Government Bodies
- Home
- Cyber-Cafes

**Start Saving Your IT And Operation Cost Now!**

## Super TC-18 Technology

With today advancement of the PC technology, your existing PC may be under utilized. Therefore, each TC-18 is designed and programmed to access the host computer's excess computing power.

Super TC-18 uses its unique licensed terminal server and WoIP™ (Windows® Over IP) technology from our technology partner to support such a multi-user environment. TC-18 terminal server is installed at the host PC to enable remote access of the host PC via a standard TCP/IP network environment. TC-18 users may remotely access their host PC contents through any type of standard network connection. It works as a data manager to handle the desktop display and remote activities from client keyboard, mouse and speaker.

The heart of TC-18 is a unique and very low cost chip architecture that does not require a traditional x86 CPU and other chipsets. It has only a small matching System on Chip (SoC) chip.

Because of this unique architecture, no upgrade and maintenance are required on TC-18 itself. As a result, there are tremendous savings over the overall IT cost.

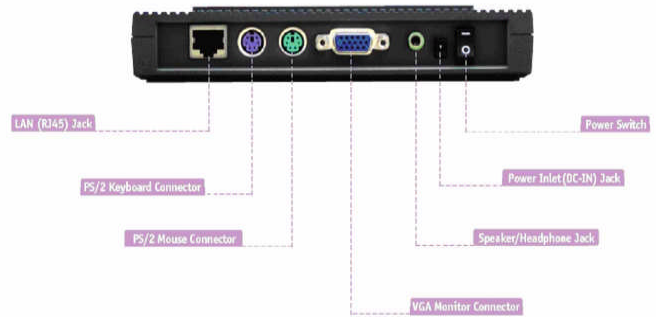

## System Specification

Electrical Specification	
Power	5V2A DC (100-240VAC Adapter included)
Video Monitor Port	RGB, DB 15 pin
Ethernet Port	RJ45
Audio Port	Speaker/Microphone 3mm Jack
Keyboard Port	PS/2 type
Mouse Port	PS/2 type
Physical Specification	
Dimension	169 mm x 128 mm x 30.5mm
Weight (grams)	260 gram
Installation	Desktop
Color	Black

## Key Differences Between a PC and a TC-18

	Traditional PC	TC-18
<b>Cost</b>	Cost over USD 1,500 per PC station.	Cut down expenses of H/W & S/W to less than USD\$230 per station.
<b>Security</b>	Exposure of outflow PC data, hacking and computer virus.	Safe from outflow PC data, hacking and computer virus (No HDD).
<b>Maintenance</b>	Difficult to control and maintain each individual computer station.	Easy maintenance because only Host PC needs to be updated/fixd. No PC de-appreciation.
<b>Power Saving</b>	Power consumption over 250W per PC.	Very little power consumption, only 5W max. (approx. 95% less than normal PC)
<b>Noise / Heat</b>	Noise & heat from CPU, HDD, VGA Fan and Power Supply Fan.	No noise and less hazardous electronic emissions.
<b>Remote Control</b>	Unable to remote access.	Easy to carry. Very portable and be able to access the Host PC with internet connection anywhere in the world.
<b>Upgrade</b>	Replacement of equipment every 2 or 3 years.	Cost effective because only Host PC needs upgrades.
<b>Space</b>	Takes up a lot of space.	Small sleek design creates huge benefit regarding space consumption.

## Recommended System Requirement

- Host PC: Any PC with 2.0GHz CPU or higher speed (with hyper threading technology)
- Protocol & Operating System: WoIP™ (Windows® over IP) for Windows® XP Home/Professional, Windows® 2000, Windows® 2000 Professional, Windows® 2000 Server, Windows® Server 2003.
- RAM: 512MB RAM or above.
- Mouse, Keyboard & Speaker are required per TC-18.
- 100Base-TX Fast Ethernet Switch is necessary if many TC-18s are connected to the host PC(s).

### Disclaimer Statements:

TC-18 is intended to reduce hardware deployment and maintenance costs. Additional software licenses may be required by the software licensors. Please check your software end user license agreement (or EULA) to ensure your continued compliance with such agreement. TCAM and her partners shall not be in the position to advise end users on licensing issues.

Specifications are subjected to change without prior notice.



### Contact:



Flexible Automation Ltd.  
Auckland  
09 273 5170